

Station	Location	Signal	Structure	Dist.	Track	Comments	Notes
1	State Highway #51	None	None	0+00	1	Right of Way	
2	State Highway #51	None	None	0+50	1	Right of Way	
3	State Highway #51	None	None	1+00	1	Right of Way	
4	State Highway #51	None	None	1+50	1	Right of Way	
5	State Highway #51	None	None	2+00	1	Right of Way	
6	State Highway #51	None	None	2+50	1	Right of Way	
7	State Highway #51	None	None	3+00	1	Right of Way	
8	State Highway #51	None	None	3+50	1	Right of Way	
9	State Highway #51	None	None	4+00	1	Right of Way	
10	State Highway #51	None	None	4+50	1	Right of Way	
11	State Highway #51	None	None	5+00	1	Right of Way	
12	State Highway #51	None	None	5+50	1	Right of Way	
13	State Highway #51	None	None	6+00	1	Right of Way	
14	State Highway #51	None	None	6+50	1	Right of Way	
15	State Highway #51	None	None	7+00	1	Right of Way	
16	State Highway #51	None	None	7+50	1	Right of Way	
17	State Highway #51	None	None	8+00	1	Right of Way	
18	State Highway #51	None	None	8+50	1	Right of Way	
19	State Highway #51	None	None	9+00	1	Right of Way	
20	State Highway #51	None	None	9+50	1	Right of Way	
21	State Highway #51	None	None	10+00	1	Right of Way	
22	State Highway #51	None	None	10+50	1	Right of Way	
23	State Highway #51	None	None	11+00	1	Right of Way	
24	State Highway #51	None	None	11+50	1	Right of Way	
25	State Highway #51	None	None	12+00	1	Right of Way	
26	State Highway #51	None	None	12+50	1	Right of Way	
27	State Highway #51	None	None	13+00	1	Right of Way	
28	State Highway #51	None	None	13+50	1	Right of Way	
29	State Highway #51	None	None	14+00	1	Right of Way	
30	State Highway #51	None	None	14+50	1	Right of Way	
31	State Highway #51	None	None	15+00	1	Right of Way	
32	State Highway #51	None	None	15+50	1	Right of Way	
33	State Highway #51	None	None	16+00	1	Right of Way	
34	State Highway #51	None	None	16+50	1	Right of Way	
35	State Highway #51	None	None	17+00	1	Right of Way	
36	State Highway #51	None	None	17+50	1	Right of Way	
37	State Highway #51	None	None	18+00	1	Right of Way	
38	State Highway #51	None	None	18+50	1	Right of Way	
39	State Highway #51	None	None	19+00	1	Right of Way	
40	State Highway #51	None	None	19+50	1	Right of Way	
41	State Highway #51	None	None	20+00	1	Right of Way	
42	State Highway #51	None	None	20+50	1	Right of Way	
43	State Highway #51	None	None	21+00	1	Right of Way	
44	State Highway #51	None	None	21+50	1	Right of Way	
45	State Highway #51	None	None	22+00	1	Right of Way	
46	State Highway #51	None	None	22+50	1	Right of Way	
47	State Highway #51	None	None	23+00	1	Right of Way	
48	State Highway #51	None	None	23+50	1	Right of Way	
49	State Highway #51	None	None	24+00	1	Right of Way	
50	State Highway #51	None	None	24+50	1	Right of Way	
51	State Highway #51	None	None	25+00	1	Right of Way	
52	State Highway #51	None	None	25+50	1	Right of Way	
53	State Highway #51	None	None	26+00	1	Right of Way	
54	State Highway #51	None	None	26+50	1	Right of Way	
55	State Highway #51	None	None	27+00	1	Right of Way	
56	State Highway #51	None	None	27+50	1	Right of Way	
57	State Highway #51	None	None	28+00	1	Right of Way	
58	State Highway #51	None	None	28+50	1	Right of Way	
59	State Highway #51	None	None	29+00	1	Right of Way	
60	State Highway #51	None	None	29+50	1	Right of Way	
61	State Highway #51	None	None	30+00	1	Right of Way	
62	State Highway #51	None	None	30+50	1	Right of Way	
63	State Highway #51	None	None	31+00	1	Right of Way	
64	State Highway #51	None	None	31+50	1	Right of Way	
65	State Highway #51	None	None	32+00	1	Right of Way	
66	State Highway #51	None	None	32+50	1	Right of Way	
67	State Highway #51	None	None	33+00	1	Right of Way	
68	State Highway #51	None	None	33+50	1	Right of Way	
69	State Highway #51	None	None	34+00	1	Right of Way	
70	State Highway #51	None	None	34+50	1	Right of Way	
71	State Highway #51	None	None	35+00	1	Right of Way	
72	State Highway #51	None	None	35+50	1	Right of Way	
73	State Highway #51	None	None	36+00	1	Right of Way	
74	State Highway #51	None	None	36+50	1	Right of Way	
75	State Highway #51	None	None	37+00	1	Right of Way	
76	State Highway #51	None	None	37+50	1	Right of Way	
77	State Highway #51	None	None	38+00	1	Right of Way	
78	State Highway #51	None	None	38+50	1	Right of Way	
79	State Highway #51	None	None	39+00	1	Right of Way	
80	State Highway #51	None	None	39+50	1	Right of Way	
81	State Highway #51	None	None	40+00	1	Right of Way	
82	State Highway #51	None	None	40+50	1	Right of Way	
83	State Highway #51	None	None	41+00	1	Right of Way	
84	State Highway #51	None	None	41+50	1	Right of Way	
85	State Highway #51	None	None	42+00	1	Right of Way	
86	State Highway #51	None	None	42+50	1	Right of Way	
87	State Highway #51	None	None	43+00	1	Right of Way	
88	State Highway #51	None	None	43+50	1	Right of Way	
89	State Highway #51	None	None	44+00	1	Right of Way	
90	State Highway #51	None	None	44+50	1	Right of Way	
91	State Highway #51	None	None	45+00	1	Right of Way	
92	State Highway #51	None	None	45+50	1	Right of Way	
93	State Highway #51	None	None	46+00	1	Right of Way	
94	State Highway #51	None	None	46+50	1	Right of Way	
95	State Highway #51	None	None	47+00	1	Right of Way	
96	State Highway #51	None	None	47+50	1	Right of Way	
97	State Highway #51	None	None	48+00	1	Right of Way	
98	State Highway #51	None	None	48+50	1	Right of Way	
99	State Highway #51	None	None	49+00	1	Right of Way	
100	State Highway #51	None	None	49+50	1	Right of Way	

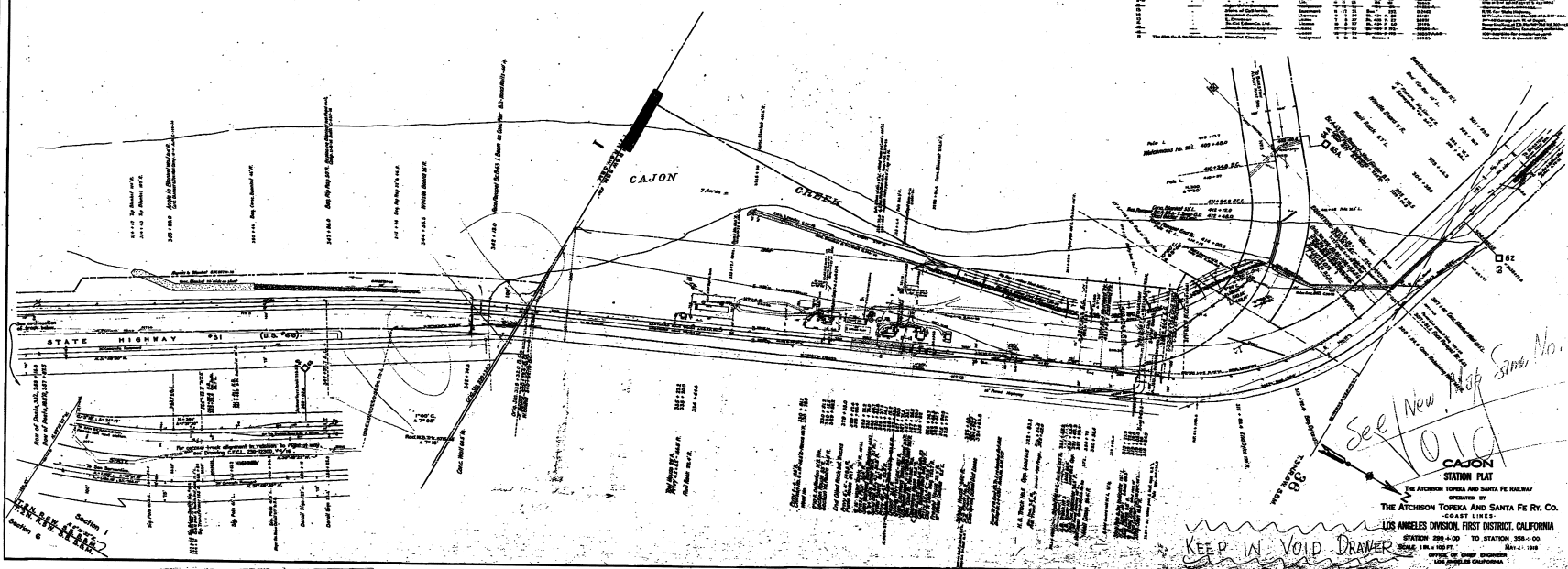

See New Map Same No.

CAJON STATION PLAT

THE ATCHAFALAYA TOPEKA AND SANTA FE RAILWAY
 OPERATED BY
THE ATCHAFALAYA TOPEKA AND SANTA FE RY. CO.
 -COAST LINE-
LOS ANGELES DIVISION, FIRST DISTRICT, CALIFORNIA

STATION 388+00 TO STATION 358+00
 SCALE: 1 IN. = 100 FT.
 OFFICE OF CHIEF ENGINEER
 LOS ANGELES, CALIFORNIA

KEEP IN VOID DRAWER